

WHEEL HUB ASSEMBLIES

4 Bolt, 5" Bolt Circle, 3.62 Pilot 1250 to 1500 pound capacity

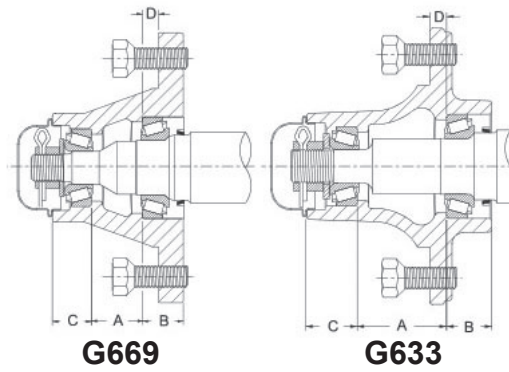

Dimensional Information

Stock #	Sequence #	Wt. Lbs.	Dimensions				Cap Lbs.	Price Per/ ea
			A	B	C	D		
G669	622006	6.50	1.16	0.94	0.88	0.38	1250 *	\$148.36
G633	622005	7.00	2.00	1.00	1.12	0.38	1500 *	153.85

Wheel Hub Assemblies include:
 Bearing Cups, Bearing Cones, Wheel Bolts, Hub Cap and Grease Seal.

Spindle Assemblies are sold separately.

*Hub capacity is based on .38 negative wheel offset (inset)
 ** Dimensions are given on the drawing.

Components

Stock #	Inner Cup	Outer Cup	Inner		Outer		Wheel Bolt	Hub Cap	Grease Seal	Spindle No. ^{^^}
			Cone	Bore	Cone	Bore				
G669	LM67010	LM11910	LM67048	1.25	LM11949	0.75	54000820	56102211	14979	521-0163
G633	LM67010	LM11910	LM67048	1.25	LM11949	0.75	4000820	56102211	14979	525-0163

^{^^} Spindle is NOT included with Wheel Hub Assembly.

ASK FOR QUANTITY DISCOUNT Prices subject to change without notice.

WHEEL HUB ASSEMBLIES

F3

5 Bolt, 4.5" Bolt Circle, 2.62 Pilot 1700 pound capacity

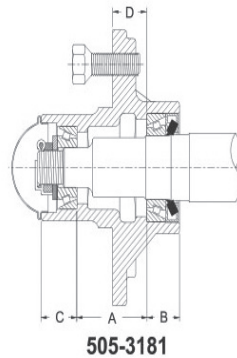

Dimensional Information

Stock #	Sequence #	Wt. Lbs.	Dimensions				Cap Lbs.	Price Per/ ea
			A	B	C	D		
505-3181 ^	622007	5.5	1.88	0.9	0.97	0.92	1750 *	\$134.09

Wheel Hub Assemblies include:

Bearing Cups, Bearing Cones, Wheel Bolts, Hub Cap and Grease Seal.
Wheel Hub Assembly 505-3181 fits two sizes of Spindles.

Spindle Assemblies are sold separately.

Bearing Cups, Bearing Cone and Grease Seal interchange information.

^ Wheel Hub Assembly fits both Plymouth and Ford car rims in offroad applicaions.

* Hub capacity is based on 1.00 positive offset (outset).

Components

Stock #	Inner Cup	Outer Cup	Inner		Outer		Wheel Bolt	Hub Cap	Grease Seal	Spindle No. ^{^^}
			Cone	Bore	Cone	Bore				
505-3181	L68111	LM12711	L68149	1.38	LM12749	0.87	54000820	56102211	14283	522-0150
505-3181	L68111	LM12711	L68149	1.38	LM12749	0.87	54000820	56102211	14293	522-0175

^{^^} Spindle is NOT included with Wheel Hub Assembly.

Prices subject to change without notice. **ASK FOR QUANTITY DISCOUNT**

1-800-228-9222 / e-mail: sales@baumhydraulics.com

Fax: 1-800-832-2522 / www.baumhydraulics.com / © Baum Hydraulics Corporation

BAUM HYDRAULICS CORPORATION

WHEEL HUB ASSEMBLIES

5 Bolt, 5.5" Bolt Circle, 4.00 Pilot 1650 to 2760 pound capacity

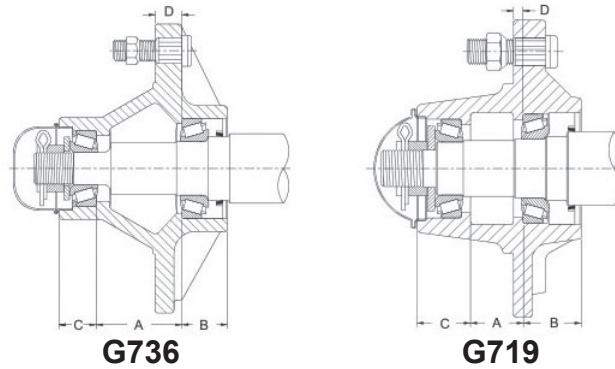

Dimensional Information

Stock #	Sequence #	Wt. Lbs.	A	Dimensions			Cap Lbs.	Price Per/ ea
				B	C	D		
G736	622009	10.00	2.00	1.00	.94	.62	1650 *	\$198.70
G719	622008	13.00	1.56	1.25	1.06	.22	2760 *	159.98

Wheel Hub Assemblies include:
 Bearing Cups, Bearing Cones, Wheel Bolts, Wheel Nuts Hub Cap and Grease Seal.
 Sprindle Assemblies are sold separately.

Bearing Cups, Bearing Cone and Grease Seal interchange information.

^ Wheel Hub Assembly fits both Plymouth and Ford car rims in offroad applicaions.

* Hub capacity is based on .25 negative offset (inset).

Components

Stock #	Inner Cup	Outer Cup	Inner		Outer		Wheel Bolt	Wheel Nut	Hub Cap	Grease Seal	Spindle No. ^{^^}
			Cone	Bore	Cone	Bore					
G736	LM67010	LM11910	LM67048	1.25	LM11949	.75	541-0820	550-0820	561-2209	14979	525-0163
G719	LM48510	LM67010	LM48548	1.38	LM67048	1.25	54100820	550-0820	560-2008	15190	523-0175

^{^^} Spindle is NOT included with Wheel Hub Assembly.

ASK FOR QUANTITY DISCOUNT Prices subject to change without notice.

WHEEL HUB ASSEMBLIES

F5

6 Bolt, 5.5" Bolt Circle, 3.37 Pilot 2600 pound capacity

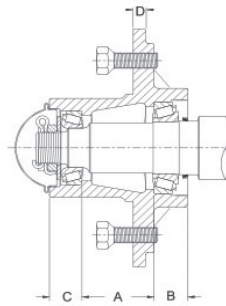

506-3192

Dimensional Information

Stock #	Sequence #	Wt. Lbs.	Dimensions				Cap Lbs.	Price Per/ ea
			A	B	C	D		
506-3192 [^]	622010	9.00	2.16	1.00	0.97	.62	2600*	\$185.03

Wheel Hub Assemblies include:

Bearing Cups, Bearing Cones, Wheel Bolts, Hub Cap and Grease Seal.
Spindle Assemblies are sold separately.

Bearing Cups, Bearing Cone and Grease Seal interchange information.

[^] Wheel Hub Assembly 506-3192 fits two sizes of Spindles.

* Hub capacity is based on .50 offset (outset).

Components

Stock #	Inner Cup	Outer Cup	Inner		Outer		Wheel Bolt	Hub Cap	Grease Seal	Spindle No. ^{^^}
			Cone	Bore	Cone	Bore				
506-3192	LM501310	LM67010	LM501349	1.63	LM67048	1.25	540-0820	560-2008	542721	526-0175
506-3192	LM501310	LM67010	LM501349	1.63	LM67048	1.25	540-0820	560-2008	542721	526-0200

^{^^} Spindle is NOT included with Wheel Hub Assembly.

Prices subject to change without notice.

ASK FOR QUANTITY DISCOUNT

1-800-228-9222 / e-mail: sales@baumhydraulics.com

Fax: 1-800-832-2522 / www.baumhydraulics.com / © Baum Hydraulics Corporation

BAUM HYDRAULICS CORPORATION

WHEEL HUB ASSEMBLIES

6 Bolt, 6" Bolt Circle, 4.62 Pilot 1650 to 4910 pound capacity

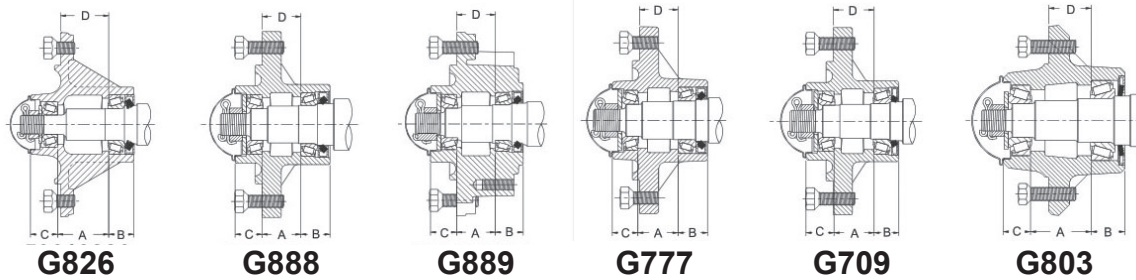

Dimensional Information

Stock #	Sequence #	Wt. Lbs.	Dimensions				Cap Lbs.	Price Per/ ea
			A	B	C	D		
G826	622014	9	2	1	1.12	1.88	1650*	\$145.88
G888	622015	11	1.52	1.12	1.06	1.52	3560*	157.03
G889	622016	16	1.52	1.12	1.06	1.52	3560*	200.11
G777	622012	11	1.56	1	1.06	1.5	3560*	159.59
G709	622011	11	1.56	1	1.06	1.59	2760*	155.54
G803	622013	21	2.5	1.38	1.13	1.75	4910*	252.79

Wheel Hub Assemblies include:
 Bearing Cups, Bearing Cones, Wheel Bolts, Hub Cap and Grease Seal.
 Spindle Assemblies are sold separately.

Bearing Cups, Bearing Cone and Grease Seal interchange information.

*Wheel Hub Assembly 50610888 and 50612889 fit two sizes of Spindles.

+ Brake Hubs

* Hub capacity is based on 1.12 positive wheel offset (outset).

Components

Stock #	Inner Cup	Outer Cup	Inner		Outer		Wheel Bolt	Hub Cap	Grease Seal	Spindle No. ^{^^}
			Cone	Bore	Cone	Bore				
G826	LM67010	LM11910	LM67048	1.25	LM11949	0.75	54000820	56102211	14979	525-0163
G888	JL69310	LM67010	JL69349	1.5	LM67048	1.25	540-0820	560-2008	16289	524-0175
G888	JL69310	LM67010	JL69349	1.5	LM67048	1.25	540-0820	560-2008	16289	524-0200
G889	JL69310	LM67010	JL69349	1.5	LM67048	1.25	540-0820	560-2008	16289	524-0175
G889	JL69310	LM67010	JL69349	1.5	LM67048	1.25	540-0820	560-2008	16289	524-0200
G777	LM29710	LM67010	LM29749	1.5	LM67048	1.25	540-0820	560-2008	16289	530-0715
G709	LM48510	LM67010	LM48548	1.38	LM67048	1.25	540-0820	560-2008	15190	523-0175
G803	25520	25821	25590	1.8	25877	1.38	54000918	562-2207	20148	527-0212

^{^^} Spindle is NOT included with Wheel Hub Assembly.

ASK FOR QUANTITY DISCOUNT Prices subject to change without notice.

WHEEL HUB ASSEMBLIES

F7

8 Bolt, 8" Bolt Circle, 6.00 Pilot 4910 to 9000 pound capacity

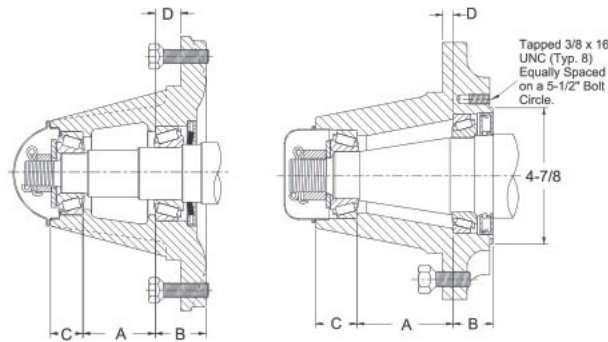

G778

5080090

Dimensional Information

Stock #	Sequence #	Wt. Lbs.	A	Dimensions B	C	D	Cap Lbs.	Price Per/ ea
G778	622017	45	2.50	1.75	1.12	.88	4910*	\$392.15
50800900+	636479	45	3.44	1.31	1.63	.38	9000**	502.29

Wheel Hub Assemblies include:

Bearing Cups, Bearing Cones, Wheel Bolts, Wheel Nuts, Hub Cap and Grease Seal.

Spindle Assemblies are sold separately.

Bearing Cups, Bearing Cone and Grease Seal interchange information.

*Wheel Hub Assembly 50610888 and 50612889 fit two sizes of Spindles.

+ Brake Hubs

* Hub capacity is based on 0.0 offset.

** Hub capacity is based on .56 positive wheel offset (outset).

Components

Stock #	Inner Cup	Outer Cup	Inner		Outer		Wheel Bolt	Hub Cap	Grease Seal	Spindle No.^
			Cone	Bore	Cone	Bore				
G778	25520	25821	25590	1.80	25877	1.38	54000918	562-2207	20148	527-0712
50800900	LM613410	25521	LM613449	2.75	25580	1.75	54000918	561-2618	28848	528-0300

^^ Spindle is NOT included with Wheel Hub Assembly.

Prices subject to change without notice. **ASK FOR QUANTITY DISCOUNT**

1-800-228-9222 / e-mail: sales@baumhydraulics.com

Fax: 1-800-832-2522 / www.baumhydraulics.com / © Baum Hydraulics Corporation

BAUM HYDRAULICS CORPORATION

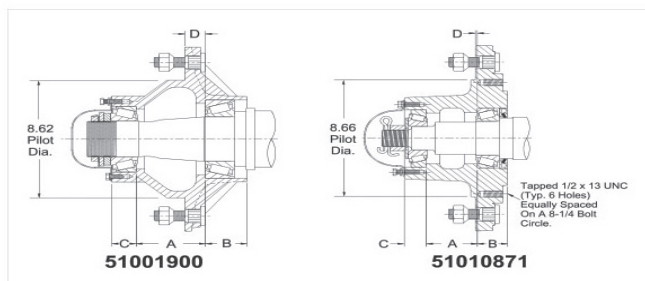
F8**WHEEL HUB ASSEMBLIES****10 Bolt, 11.25" Bolt Circle, 8.62 Pilot and 8.66 Pilot 19,000 to 13,800 pound capacity****Dimensional Information**

Stock #	Sequence #	Wt. Lbs.	Dimensions				Cap Lbs.	Price Per/ ea
			A	B	C	D		
51001900	636478	55	4.27	2.32	1.35	1.55	19000*	\$661.57
51010871+	636480	66	2.81	1.72	1.28	.06	13800**	1105.97

Wheel Hub Assemblies include:
 Bearing Cups, Bearing Cones, Wheel Bolts, Wheel Nuts, Hub Cap and Grease Seal.
 Spindle Assemblies are sold separately.

Bearing Cups, Bearing Cone and Grease Seal interchange information.

+ Brake Hubs

* Hub capacity is based on 0.0 offset.

** Hub capacity is based on .56 positive wheel offset (outset).

Components

Stock #	Inner Cup	Outer Cup	Inner		Outer		Wheel Bolt	Wheel Nut	Hub Cap	Grease Seal	Spindle No. ^{^^}
			Cone	Bore	Cone	Bore					
51001900	653	HM212011	663	3.25	HM212049	2.63	54101216	55001216	563-3600	40108	529-0450
51010871	39520	453A	39585	2.50	460	1.75	54101216	54101216	564-2700	30095	531-0312

^{^^} Spindle is NOT included with Wheel Hub Assembly.

ASK FOR QUANTITY DISCOUNT Prices subject to change without notice.

BAUM HYDRAULICS CORPORATION

1-800-228-9222 / e-mail: sales@baumhydraulics.com
 Fax: 1-800-832-2522 / www.baumhydraulics.com / © Baum Hydraulics Corporation

SPINDLE ASSEMBLIES

F9

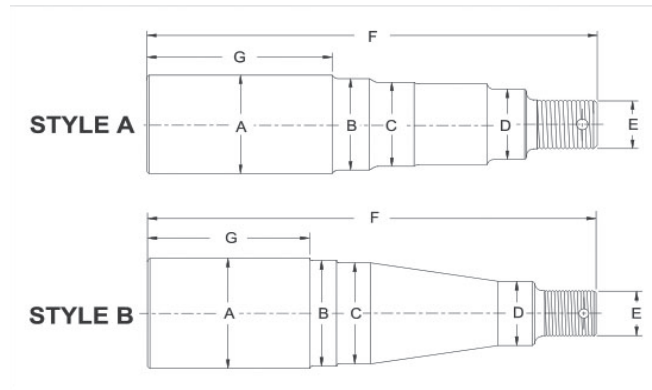

Dimensional Information

Stock #	Sequence #	Wt. Lbs.	Style	A	B	C	D	E UNF Thds.	F	G	Price Per/ ea
521-0163	636506	4.50	A	1.63	1.50	1.2495/1.2480	.7495/.7480	5/8 X 18	9.00	5.34	\$53.73
522-0150	636491	6.00	A	1.50	1.44	1.3767/1.3747	.8650/.8630	3/4 X 16	11.00	6.88	63.88
522-0175	622000	7.00	A	1.75	1.44	1.3767/1.3747	.8650/.8630	3/4 X 16	11.75	7.63	76.36
523-0175	636493	7.00	A	1.75	1.50	1.3745/1.3735	1.2495/1.2485	7/8 X 14	11.50	7.12	71.94
524-0175	636494	8.00	A	1.75	1.63	1.4951/1.4941	1.2495/1.2485	7/8 X 14	12.50	8.07	66.09
524-0200	636495	10.50	A	2.00	1.63	1.4951/1.4941	1.2495/1.2485	7/8 X 14	14.00	9.57	94.04
525-0163	622001	5.00	A	1.63	1.50	1.2495/1.2480	.7495/.7480	3/4 X 16	10.38	5.79	57.83
526-0175	622002	9.00	A	1.75	1.69	1.6245/1.6235	1.2495/1.2485	1 X 14	14.00	9.15	81.11
526-0200	622003	11.00	A	2.00	1.69	1.6245/1.6235	1.2495/1.2485	1 X 14	14.00	9.15	93.96
527-0212	636499	13.00	A	2.12	2.00	1.7955/1.7945	1.3745/1.3735	7/8 X 14	15.44	9.33	110.39
528-0300	636488	28.00	B	3.00	2.88	2.7495/2.7480	1.7495/1.7480	1-1/4 X 12	15.44	8.12	215.28
529-0450	636489	51.00	B	4.12	4.00	3.2495/3.2480	2.6245/2.6230	2-5/8 X 16	15.38	6.00	422.61
530-0175	622004	8.00	A	1.75	1.63	1.4995/1.4985	1.2495/1.2485	7/8 X 14	12.50	8.03	70.42
531-0312	636487	34.00	A	3.12	3.00	2.4995/2.4985	1.7495/1.7485	1-1/4 X 12	17.38	10.00	258.65

Spindle Assemblies include: Washer, Nut and Cotter Pin.

Wheel Hub Assemblies are sold separately.

Prices subject to change without notice. **ASK FOR QUANTITY DISCOUNT**

1-800-228-9222 / e-mail: sales@baumhydraulics.com

Fax: 1-800-832-2522 / www.baumhydraulics.com / © Baum Hydraulics Corporation

BAUM HYDRAULICS CORPORATION

F10

HUBS & SPINDLES FOR FARM IMPLEMENT WHEELS WITH & WITHOUT GREASE FITTINGS

HUBS ONLY - BEST SELLING HUBS STOCKED IN QUANTITY

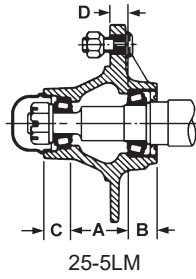

25-5LM

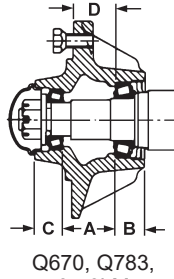

Q670, Q783,
35-6LM

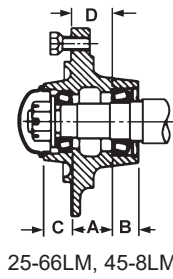

25-66LM, 45-8LM

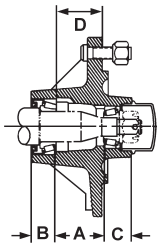

30-66LM

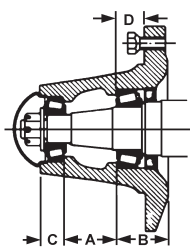

Q821, Q848

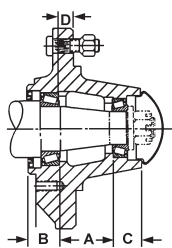

60-8LM

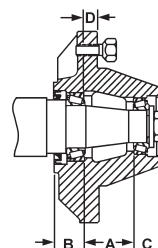

80-8LM

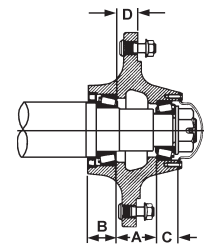

Q881

New Hub Casting Number	Fits Spindle Number	Capacity Lbs.	Hub Only Price Per Piece	Inner Bearing Cone Number	Outer Bearing Cone Number	Oil Seal Number	Grease Cap Number	Wheel Bolt Number	A	B	C	D
5 BOLT ON 5-1/2" BOLT CIRCLE, 4" PILOT, WITH LIP												
25-5LM+	105708K	2,500	75.07	LM48548	LM67048	17617	1604	0611878	1.56	1.03	.94	.19
6 BOLT ON 6" BOLT CIRCLE, 4-5/8" PILOT												
25-66LMG	105708K	2,500	100.07	LM48548	LM67048	17617	1604	0611878	1.56	1.03	.94	1.44
30-66LM	106753A	3,000	79.91	LM29749	LM67048	17617	1604	LB-506	2.19	1.00	.94	1.94
Q670*	0203161	3,230	106.79	342A	14137A	22870	1526	90D0613945	1.62	1.13	1.75	1.81
35-6LMG+	106169A	3,500	108.21	LM501349	LM67048	20044	1604	90D0608723	2.84	1.44	.97	1.56
8 BOLT ON 8" BOLT CIRCLE, 6" PILOT												
45-8LMG	106272B	4,500	174.99	LM603049	LM67048	22392	1604	90D0608723	2.83	1.26	.94	1.38
Q821	0205574	5,790	86.50	3780	2790	25091	1607	90D0616460	2.44	2.41	1.25	1.34
60-8LM+	107007A	6,000	178.28	JLM506849	LM501349	27394	1609	0616471	2.56	1.50	1.44	.75
80-8LM+	281316	8,000	192.26	JLM506849	LM501349	27394	1609	90DWD9275	2.72	1.50	1.37	.83
Q848	0317846	8,000	313.21	39581	3585	35062	9301	90D0608723	3.22	1.28	1.40	1.84
10 BOLT ON 13-3/16" CIRCLE, 11.05" PILOT												
Q881	2819000	20,000	724.62	HM218248	HM212049	43771	502041	0617512	3.25	2.28	1.72	1.66

* Inner bearing cone has extended inner race that seal rides on.
+ French & Hecht Style.

ASK FOR QUANTITY DISCOUNT Prices subject to change without notice.

BAUM HYDRAULICS CORPORATION

1-800-228-9222 / e-mail: sales@baumhydraulics.com
Fax: 1-800-832-2522 / www.baumhydraulics.com / © Baum Hydraulics Corporation

FARM IMPLEMENT SPINDLES

F11

AGRICULTURAL STRAIGHT ROUND SPINDLES FOR FARM IMPLEMENTS FOR 20 MPH SPEED -

Made of round hot rolled steel, ready to be welded into tubing. Interchange with electric wheel and french and hecht.

Spindle Number	Capacity Spindle Lbs.	Fits Hub	Price Per Piece	A Bar Stock Size	B Seal Seat Diam.	C Inner Bearing Diam.	D Outer Bearing Diam.	E Thread Diam.	F Overall Length	G Length	M Thread Length
105708K+	2,500	25-5LM 25-66LM	76.33	1-3/4	1.75	1.375	1.25	3/4	12-5/16	3.59	1.25
0203161	3,230	Q670	57.76	2	2.00	1.625	1.375	7/8	11	4.56	1.28
106753A+	3,000	30-66LM	71.32	1-3/4	1.75	1.50	1.25	3/4	9-7/8	4.62	1.10
106169A+	3,500	35-6LM	88.66	2	2.00	1.625	1.25	3/4	11	5.22	1.10
SA-3000	3,500	QD82-13	21.65	2-1/4	2.25	1.759	1.249	1	9-1/2	4.04	--
0205574	5,790	Q821	162.40	2-3/4	2.50	2.00	1.31	7/8	17-53/64	5.62	1.25
0317846	8,000	Q848	296.49	3-5/8	3.50	2.25	1.625	1-1/4	15-1/2	7.50	1.00
03185741	8,000	Q886	92.00	3-1/8	3.00	2.25	1.37	7/8	16	6.50	--
106272B+	4,500	45-8LM	122.54	2-1/4	2.25	1.78	1.25	3/4	14	5.37	1.06
107007A+	6,000	60-8LM	151.59	2-3/4	2.75	2.16	1.62	1	14	5.50	1.38
281316+	8,000	80-8LM	259.74	3	2.75	2.16	1.62	1	16	6.50	1.38
281916	20,000	Q881	4-1/2	4.38	3.54	2.62	2	26-1/2	8.87	--

+ French & Hecht Style, Cold Rolled Steel Spindles.

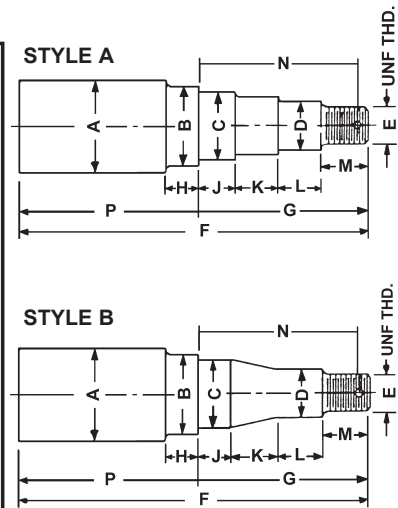

COMPLETE HUB & SPINDLE GROUPS FOR FARM IMPLEMENTS -

Hub Groups Include All Necessary Components For Hub and Spindle Shipped In Bulk

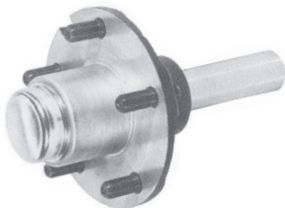

HUBS MAY BE STOCKED WITH OR WITHOUT GREASE FITTINGS

To Order Hubs with Grease Fittings Add G on the end of the Part Number.

Complete Hub Group Number	Price Per Piece
5 BOLT ON 5-1/2" BOLT CIRCLE, 4" PILOT	
25-5LM	188.00
6 BOLT ON 6" BOLT CIRCLE, 4-5/8" PILOT	
Q826	171.42
Q670	300.94

Complete Hub Group Number	Price Per Piece
6 BOLT ON 6" BOLT CIRCLE, 4-5/8" PILOT	
Q783G	\$197.01
25-66LM	182.23
30-66LM	224.83
35-6LMG	211.75
8 BOLT ON 8" BOLT CIRCLE, 6" PILOT	
Q821G	603.28
Q848	878.55
45-8LMG	327.53
60-8LMG	357.29
80-8LM	526.92

Prices subject to change without notice.

ASK FOR QUANTITY DISCOUNT

1-800-228-9222 / e-mail: sales@baumhydraulics.com

Fax: 1-800-832-2522 / www.baumhydraulics.com / © Baum Hydraulics Corporation

BAUM HYDRAULICS CORPORATION

FARM IMPLEMENT PARTS STUD SCREWS, GREASE CAPS, RINGS & WASHERS

FINE CONICAL HEAD WHEEL STUD SCREWS - Pkg. Qty. 20

FINE THREAD

USED WITHOUT NUTS IN TAPPED HUBS

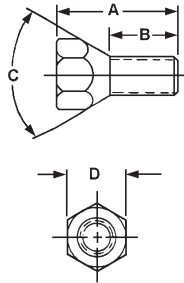

Part Number	Diam. Inches	A Overall Length Inches	B Thread Length Inches	C Head Angle Degrees	D Hex Diam. Inches	Price Per Piece
GRADE 5 - 90° TAPER - FINE THREAD						
90DLB509*	1/2	x 1-3/8	7/8	90°	13/16	\$2.62
90D0608449	1/2	x 1-1/2	1	90°	3/4	0.89
90D0613945	1/2	x 1-3/4	1-1/4	90°	3/4	2.97
90D0617820	1/2	x 2-1/4	1-1/2	90°	3/4
90DWD91071	1/2	x 2-5/16	1-3/4	90°	3/4	3.94
90DLB569*	9/16	x 1-5/8	1-1/8	90°	7/8	5.92
90D0608723	9/16	x 1-11/16	1-1/8	90°	7/8	6.23
90D0616460	9/16	x 2-1/8	1-1/2	90°	7/8	10.58
90D0617925	9/16	x 2-5/8	2	90°	7/8	2.59
90DWD9275	5/8	x 2-3/8	1-3/4	90°	15/16	5.85
90DWD9731	5/8	x 3-5/8	3	90°	15/16	9.39
GRADE 8 - 90° TAPER - FINE THREAD						
90D0618025	5/8	x 2-3/4	1-7/8	90°	15/16
GRADE 5 - 60° TAPER - FINE THREAD LB-506						
	1/2	x 1-1/2	7/8	60°	13/16	2.47

NOTE: DWD Used with some dual wheels
 *90DLB509 & 90DLB569 Phosphate Oil Treated, All Others are Plated

FINE SPLINED FLAT HEAD WHEEL STUD SCREWS - Pkg. Qty. 20

FINE THREAD - GRADE 5

USED WITH CONICAL NUTS IN DRILLED HUBS

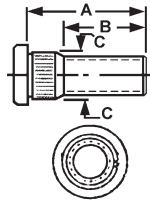

Part Number	Diam. Inches	A Overall Length Inches	B Thread Length Inches	C Spline Diam. Inches	Price Per Piece
GRADE 5					
0613717	1/2	x 2-1/16	1-1/2	.612	\$0.74
ST-502-04	1/2	x 2	1-3/8	.543	2.96
ST-504 *	1/2	x 2-1/4	1-3/8	.606	3.73
ST-562	9/16	x 2-1/8	1-3/8	.606	3.80
0612730	9/16	x 2-1/8	1-3/8	.617	1.28
ST-625	5/8	x 2-1/2	1-3/8	.682	4.32
953033 *	3/4	x 2-13/16	1-13/16	1.00	6.67
91036DWD +	7/8	x 3-1/2	2-3/4	1.00	19.04

*ST-504 and 953033 are Grade 8 + Coarse Thread

FINE CONICAL NUTS TO FIT FINE SPLINED FLAT HEAD WHEEL STUD SCREWS - Pkg. Qty. 20

GRADE 5

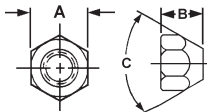

Part Number	Thread Size	A	B	C	Price Per Piece
0611878	1/2-20	13/16	5/8	90	\$1.80
STN-569	9/16-18	1	11/16	90	4.00
0616471	5/8-18	15/16	23/32	90	0.81
912935	3/4-16	1-1/2	7/8	100	5.36

FLANGE NUTS - GRADE 5 - Pkg. Qty. 20

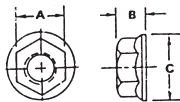

Part Number	Thread Size	A	B	C	Price Per Piece
0617512	3/4-16	1-1/8	21/32	1-1/2	\$2.15

AG SPINDLE WASHERS FOR HUBS - TYPE 3 - PLAIN FINISH -

Pkg. Qty. 20

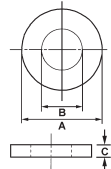

Part Number	A O.D.	B I.D.	C Width	Price Per Piece
SW-625	1.312	.668	.095	\$3.60
SW-750	1.750	.820	.187	1.85
SW-751	1.500	.795	.125	4.89
SW-875	2.000	.950	.164	4.89
SW-1001	2.140	1.070	.250	7.23

ASK FOR QUANTITY DISCOUNT Prices subject to change without notice.

GREASE CAPS - Qty. Pkg. 4

A-Flange Diam. (O.D.)
 B-Crown Height
 C-Flange Length
 D-Overall Height

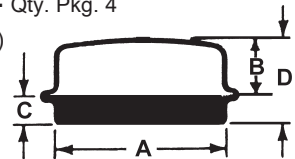

Part Number	Material Thickness	A Flange Diam.	B Crown Height	C Flange Length	D Overall Height	Price Per Piece
1503	.032	1.785	1.16	.375	1.53	\$5.01
1524	.032	1.943	1.10	.281	1.38	5.48
1527	.037	1.957	1.04	.340	1.38	10.37
9099	.063	1.969	.625	.438	1.062	4.53
1505	.032	1.986	.78	.375	1.16	4.12
1601	.059	2.331	.81	.440	1.25	6.93
1520	.032	2.448	1.03	.312	1.34	5.01
1604	.059	2.448	.88	.281	1.16	13.18
1606	.059	2.503	.56	.312	.94
1605	.059	2.717	1.03	.312	1.34	18.96
1526	.037	2.720	1.13	.312	1.44	6.93
1609	.059	3.125	1.03	.281	1.31	8.92
1607	.059	3.155	1.19	.187	1.38	9.63
1528	.037	3.355	1.06	.560	1.62
9301	.070	3.950	2.13	.310	2.44	19.46

WHEEL REINFORCING RINGS -

FOR BOTH FORMED WHEELS & FLAT WHEELS

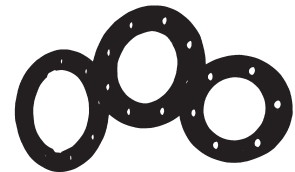

Part Number	No. Of Bolt Holes	Bolt Circle Inches	Pilot Diam Inches	Ring Outside Diameter	Plate Thickness Inches	Price Per Piece
60E19 - Fits bolt sizes: 1/2 & 9/16 inches						
	6	x 6	x 4-5/8	8	1/4	\$50.19
80E19 - Fits bolt sizes: 9/16 & 5/8 inches						
	8	x 8	x 6	10-1/4	5/16	62.76
81E19 - Fits bolt sizes: 9/16 & 5/8 inches						
	9	x 9-1/2	x 7-3/4	11-3/4	5/16	99.43
91E19 - Fits bolt size: 7/8 inches						
	10	x 13-3/16	x 11-1/16	16	3/8	158.52

WHEEL REPAIR WASHERS -

Used for repairing and reinforcing wheel studs by welding them over the worn and enlarged holes. Can be used on farm wagons, etc. with 1/2" & 9/16" studs. Heavy gauge steel slightly convexed with bevel edge.

Part Number	Price Per 100
Wheel Repair	\$60.89

