

DANUSER BALL SOCKETS

C01

BALL SOCKETS - Socket pressure-formed of seamless tubing. **Use Low-Hydrogen Type 616 or Ni-Rod Nickel Welding Rod.**

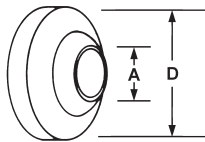
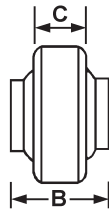
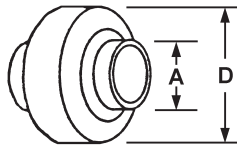

Danuser Unplated Part Number	A Pin Hole Diam. Inches	B Length Thru Bore Inches	C Greatest Sleeve Width Inches	D Sleeve Overall Diam. Inches	Price Per Piece
5/8" Lift Arm Ball Sockets - Category 0					
5870	5/8	1	3/8	2	\$8.58
7/8" Lift Arm Ball Sockets - Category 1					
5088	7/8	1-3/8	9/16	2-1/4	13.77
5827	7/8	1-3/8	3/8	2-1/2	17.55
1-1/8" Lift Arm Ball Sockets - Category 2					
5859	1-1/8	1-3/8	3/8	3-1/8	24.99
5836	1-1/8	1-3/4	9/16	3-1/8	29.15
1-7/16" Lift Arm Ball Sockets - Category 0					
5865	1-7/16	1-3/4	1/2	3-1/2	37.88
5/8" Top Link Ball Sockets - Category 1					
5870	5/8	1	3/8	2	8.58
3/4" Top Link Ball Sockets - Category 1					
5868	3/4	1	3/8	2	8.58
5500	3/4	1-3/4	3/8	2	10.42
5347	3/4	1-3/8	9/16	2-1/4	13.77
5860	3/4	1-3/8	3/8	2-1/2	17.55
1" Top Link Ball Sockets - Category 2					
7466	1	1	3/8	2	8.58
5526	1	1-3/4	7/8	2-3/4	22.15
5849	1	1-3/4	9/16	3-1/8	29.15
1-1/4" Top Link Ball Sockets - Category 3					
5924	1-1/4	1-3/4	7/8	2-3/4	22.04
5925	1-1/4	1-3/4	9/16	3-1/8	28.50
5910	1-3/4	2-1/2	1	4-1/2	118.28

Prices subject to change without notice. **ASK FOR QUANTITY DISCOUNT**

1-800-228-9222 / e-mail: sales@baumhydraulics.com
 Fax: 1-800-832-2522 / www.baumhydraulics.com / © Baum Hydraulics Corporation

BAUM HYDRAULICS CORPORATION



Ball Socket
 • Weld-on top link and lift arm ball sockets
 • Fits Category 0 through 3 tractors
 • Plain and zinc plated (ZP)

Plain P/N	Price	ZP P/N	Price	Type	Cat	Hole Size	Bore Length	Outside Sleeve	Wt Ea
22460	\$12.11	----	\$....	Top Link	0	5/8"	1"	2"	0.6
22413	11.51	22813	9.85	Top Link*	1	3/4"	1-5/8"	2"	0.7
22470	13.22	22870	11.13	Top Link HD*	1	3/4"	1-5/8"	2-1/8"	0.7
22472	13.96	22872	11.32	Top Link HD	1	3/4"	1-3/8"	2-3/8"	0.9
22474	22874	15.72	Top Link	1 & 2	3/4" & 1"	1-1/2" & 1-1/4"	2-3/8"	0.6
22411	16.21	22811	16.46	Top Link*	2	1"	1-3/4"	2-3/8"	0.8
22473	18.25	22873	15.72	Top Link HD	2	1"	1-3/4"	2-3/4"	1.8
22476	15.97	22876	13.19	Top Link	2	1"	1-1/4"	2-3/8"	0.8
22477	15.89	22877	13.00	Top Link	2	1"	1-3/32"	2-3/8"	0.7
22478	26.09	22878	22.77	Top Link	3	1-1/4"	1-3/4"	3-1/8"	1.8
22421	14.06	22821	15.21	Lift Arm	1	7/8"	1-3/8"	2-3/8"	0.9
22480	14.06	22880	13.00	Lift Arm	1	7/8"	1-3/8"	2-3/8"	0.9
22482	26.47	22882	22.50	Lift Arm	1 & 2	7/8" & 1-1/8"	1-3/4"	2-3/4"	1.4
22483	27.26	22883	23.04	Lift Arm	1 & 2	7/8" & 1-1/8"	1-3/4"	3-1/8"	1.7
22422	15.70	22822	13.22	Lift Arm	2	1-1/8"	1-5/16"	2-3/8"	0.8
22485	25.60	22885	21.98	Lift Arm	2	1-1/8"	1-3/4"	3-1/8"	1.9
22486	18.66	22886	15.13	Lift Arm	2	1-1/8"	1-3/4"	2-3/4"	1.6
22487	33.49	22887	32.84	Lift Arm	3	1-7/16"	1-3/4"	3-1/2"	2.4

* With shoulder

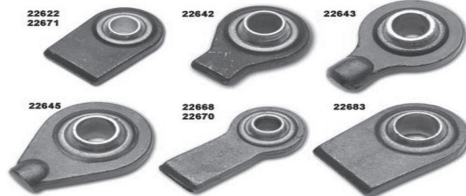
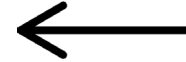

WELD-ON REPAIR END
 • High quality weld-on lift arm and top link repair ends
 • Category 1, 2 or 3

P/N	Description	Cat	Hole Dia	Overall Length	Wt Ea	Price
22622	Lift arm, Straight, Lower	1	7/8"	4-1/2"	1.8	\$22.31
22668	Lift Arm, Bent	1	7/8"	5-1/2"	2.0	23.56
22670	Lift Arm, Bent	2	1-1/8"	5-3/4"	2.7	36.64
22671	Lift Arm, Straight, Lower	2	1-1/8"	5"	3.3	32.37
22683	Lift Arm, Straight	3	1-7/16"	5-1/2"	3.5	68.80
22642	Top Link, Forged	1	3/4"	3-1/8"	1.0
22643	Top Link, Forged	2	1"	3-3/4"	1.8	20.62
22645	Top Link, Forged	3	1-1/4"	5-1/4"	4.5	50.93

REPLACEMENT BALL
 • Replacement balls for top links and lift arms
 • Zinc plated to resist corrosion

P/N	Description	Dia	Hole Length	Bal Dia	Wt Ea	Price
22441	Top Link Cat 1 JD/Oliver	3/4"	1-3/4"	2"	1.1	\$9.09
22442	Top Link Cat 2 JD/Oliver	1"	1-3/4"	2"	0.9	9.00
22443	Lift Arm Cat 1 Ford	7/8"	1-3/8"	2-1/4"	1.2	6.90
22444	Lift Arm Cat 2 Ford	1-1/8"	1-3/4"	2-1/4"	1.1	7.03
22445	Lift Arm Cat 1 Oliver	7/8"	1-3/8"	2"	0.7	6.85

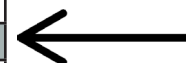

ASK FOR QUANTITY DISCOUNT Prices subject to change without notice.

**PRINCE
TOP LINK CYLINDER -**

Category II Only,
1" Swivel Pinhole, 1/2" NPT Ports

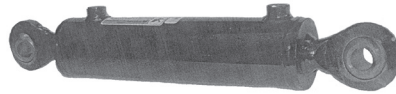

C03



Prince Weld-A-Cylinder Number	Size Inches Bore X Stroke	PSI	Shaft Diam. Inches	Overall Length Retracted Inches	Price Per Piece
BD-0228	3 X 10	3000	1-3/8	20-7/8	\$512.29

- TOP LINK**
- Adjustable top links attach upper 3-point attaching point of implement to tractor
 - Adjusting handle included
 - Yellow zinc plated
 - Category 0, 1 & 2 combination, 2 and 3

Std. Pkg. = 1 pieces



P/N	Cat	Type	Hole Dia	Thread Dia	Body Length	Closed Length	Open Length	Wt Ea	Price
22506	0	Std	5/8"	3/4"	7-5/8"	11"	16"	3.2	\$29.31
22504	0	Std	5/8"	3/4"	9-1/2"	13"	18"	2.7	42.96
22507	1	Std	3/4"	1-1/8"	11-1/4"	15-1/2"	24"	6.8	44.12
22509	1	Std	3/4"	1-1/8"	12"	16-3/8"	26-1/2"	7.0	59.47
22508	1	Std	3/4"	1-1/8"	13"	17-1/2"	26"	7.2	45.02
22510	1	Std	3/4"	1-1/8"	16"	20-1/2"	29"	8.0	42.98
22512	1	Std	3/4"	1-1/8"	20"	24-1/2"	33"	8.9	40.76
25515	1 & 2	Std	3/4"-1"	1-1/8"	16"	20-3/4"	31"	9.4	50.16
22518	2	Std	1"	1-1/8"	13"	18"	27-3/4"	9.1	59.33
22520	2	Std	1"	1-1/8"	16"	21"	33"	9.8	56.97
22522	2	Std	1"	1-1/8"	20"	25"	37"	10.7	58.11
22528	2	JD	3-4"-1"	1-1/8"	12-1/2"	21-5/8"	30"	12.0	119.68
22525	2	HD	1"	1-1/4"	15"	20-1/2"	31-1/2"	14.9	131.40
22526	2	HD	1"	1-1/4"	19"	24-1/2"	35-1/2"	13.4	111.83
22530	3	HD	1-1/4"	1-3/8"	19"	25-1/2"	36-1/2"	22.4	213.50

TOP LINK THREADED REPAIR END
• Screw-in repair ends for Category 1, 2 and 3 top links

P/N	Type	Cat	Hole Dia	Thread	Thread Length	Overall Length	Wt Ea	Price
22648	Forged	1	3/4"	1-1/8" NC (RH)	6"	10"	2.4	23.31
22649	Forged	1	3/4"	1-1/8" NC (LH)	6"	10"	2.4	23.31
22650	Forged	2	1"	1-1/8" NC (RH)	6-1/2"	11"	3.3	32.45
22651	Forged	2	1"	1-1/8" NC (LH)	6-1/2"	11"	3.3	25.74
22653	Forged	2 HD	1"	1-1/4" NC (RH)	5-1/2"	10"	4.0	29.82
22654	Forged	2 HD	1"	1-1/4" NC (LH)	5-1/2"	10"	3.3	29.82
22656	Forged	3	1-1/4"	1-3/8" NC (RH)	7-1/4"	12-1/8"	6.0	59.29
22657	Forged	3	1-1/4"	1-3/8" NC (LH)	7-1/4"	12-1/8"	8.0	59.29



DRAWBAR
• One piece drawbars replace most standard applications
• Painted black



P/N	Cat	Spacing	Holes	Hole Dia	Pin Dia	Thickness	Width	Overall Length	Wt Ea	Price
22718	0	20"	7	5/8"	5/8"	5/8"	2"	24-1/2"	6.7	\$26.31
22719	1	20"	7	3/4"	7/8"	1"	2-1/2"	25"	10.9	44.72
22711	1	26"	11	3/4"	7/8"	1"	2-1/2"	31-1/2"	16.2	49.32
22721	2	26"	11	3/4"	1-1/8"	1-1/4"	3"	32"	24.6	106.78
22732	2	32"	13	3/4"	1-1/8"	1-1/4"	3"	38"	30.2	97.17
22744	2	32"	7	1-1/8"	1-1/8"	1-1/4"	3"	38"	32.0	141.76
22748	3	38"	5	1-1/4"	1-7/16"	1-3/4"	3-1/2"	43-1/2"	65.0	213.23

Farm hardware products are not designed for lifting

Prices subject to change without notice. **ASK FOR QUANTITY DISCOUNT**

1-800-228-9222 / e-mail: sales@baumhydraulics.com
Fax: 1-800-832-2522 / www.baumhydraulics.com / © Baum Hydraulics Corporation

BAUM HYDRAULICS CORPORATION



TOP LINK BUSHING						
<ul style="list-style-type: none"> • Reducing bushing • Adapters larger category hitches to smaller category implements • Yellow zinc plated 						
P/N	Description	ID	OD	Length	Wt Ea	Price
21188	Cat 0-1	5/8"	3/4"	1-5/8"	0.10	\$2.07
21191	Cat 1-2	3/4"	1"	1-5/8"	0.15	2.09
21190	Cat 1-2	3/4"	1"	1-15/16"	0.20	2.18
21192	Cat 2-3	1"	1-1/4"	1-15/16"	.24	2.31

LIFT ARM BUSHING						
<ul style="list-style-type: none"> • Reducing bushing • Adapters larger category hitches to smaller category implements • Yellow zinc plated 						
P/N	Description	ID	OD	Length	Wt Ea	Price
21189	0-1	5/8"	7/8"	1-3/8"	0.10	\$1.91
21193	1-2	7/8"	1-1/8"	1-3/8"	0.14	2.07
21194	1-2	7/8"	1-1/8"	1-3/4"	0.19	2.04
21195	2-3	1-1/8"	1-7/16"	1-3/4"	0.30	2.67
21196	2-3 w/hole	1-1/8"	1-7/16"	2-1/2"	0.40	5.03
21197	2-3	1-1/8"	1-7/16"	2-3/4"	0.50	5.11
21198	2-3	1-1/8"	1-7/16"	3-1/4"	0.60	5.71

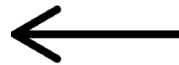

TOP LINK PIN						
<ul style="list-style-type: none"> • Top link pins connect top link to tractor and to implement • Variety of lengths will fit most applications • Category 0 through Category 3 • Yellow zinc plated 						
P/N	Cat	Pin Dia	Usable Length	Overall Length	Wt Ea	Price
21250	0	5/8"	3"	4-7/16"	0.40	\$3.35
21252	1	3/4"	2-3/4"	4-1/2"	0.50	3.21
21256	1	3/4"	3-7/8"	5-1/2"	0.66	3.67
21257	1	3/4"	4-3/4"	6-3/8"	0.80	3.94
21260	2	1"	3"	4-3/4"	1.00	8.87
21261	2	1"	3-9/16"	5-1/4"	1.13	6.28
21262	2	1"	4-5/16"	6"	1.40	6.80
21264	2	1"	5-3/8"	7"	1.53	11.81
21270	3	1-1/4"	4-7/16"	6-1/2"	2.25	17.87

ASK FOR QUANTITY DISCOUNT Prices subject to change without notice.



CLEVIS								
• Black painted finish • Yellow zinc plated pin and clip								
Std. Pkg. = 1 pieces								
P/N	Type	Dia	Usable Length	Opening Width	Pin Diameter	Working Load Limit	Wt Ea	Price
24013	Straight	5/8"	3-1/4"	3/4"	1/2"	6,000#	1.50	\$12.38
24014	Straight	3/4"	3-3/4"	1-1/4"	5/8"	12,000#	2.08	18.58
24015	Straight	7/8"	3-1/4"	1-1/4"	3/4"	16,000#	3.07	22.42
24016	Straight	7/8"	4-1/4"	1-1/4"	3/4"	16,000#	3.79	27.53
24017	Straight	15/16"	4-5/8"	1-1/4"	7/8"	20,000#	4.60	27.78
24018	Straight	1"	5-5/16"	2"	1"	25,000#	6.18	42.19
24023	Twisted	5/8"	3"	3/4"	1/2"	6,000#	1.50	14.61
24024	Twisted	3/4"	3-1/2"	1-1/4"	5/8"	12,000#	2.12	23.15
24025	Twisted	7/8"	2-3/4"	1-1/4"	3/4"	16,000#	3.00	29.92
24026	Twisted	7/8"	3-7/8"	1-1/4"	3/4"	16,000#	3.55	28.95
24027	Twisted	15/16"	4-1/4"	1-1/4"	7/8"	20,000#	4.30	29.49
24028	Twisted	1"	5"	2"	1"	25,000#	6.25	39.53
24041	Farm	1/4"	1-1/8"	7/16"	5/16"	1,000#	0.10	7.45
24042	Farm	5/16"	1-1/4"	9/16"	3/8"	2,000#	0.20	3.29
24043	Farm	3/8"	1-7/16"	5/8"	7/16"	3,000#	0.30	4.79
24044	Farm	7/16"	1-11/16"	3/4"	1/2"	4,000#	0.50	6.04
24045	Farm	1/2"	1-15/16"	3/4"	5/8"	6,500#	0.82	8.13
24046	Farm	5/8"	2-1/2"	1"	3/4"	9,000#	1.40
24047	Farm	3/4"	3"	1-1/4"	7/8"	13,000#	2.67	22.88
24048	Farm	7/8"	3-1/4"	1-1/4"	1"	15,000#	3.45	28.05
24049	Farm	1"	3-3/4"	1-3/4"	1"	17,000#	4.40	47.50
24061	Utility	1/4"	7/8"	1/2"	5/16"	1,000#	0.10	2.99
24062	Utility	5/16"	1"	5/8"	3/8"	1,500#	0.20	4.11
24063	Utility	3/8"	1-1/4"	1-2"	7/16"	2,000#	0.30	10.84
24064	Utility	7/16"	1-1/2"	1-2"	5/8"	3,000#	0.40	5.88
24065	Utility	1/2"	1-11/16"	3/4"	5/8"	6,000#	0.60	15.56
24066	Utility	5/8"	2"	1"	3/4"	9,000#	1.20	10.47
24082	General	3/4"	6-1/4"	2-1/4"	3/4"	13,000#	3.43	28.73

Farm hardware products are not for lifting

Prices subject to change without notice. **ASK FOR QUANTITY DISCOUNT**

1-800-228-9222 / e-mail: sales@baumhydraulics.com
 Fax: 1-800-832-2522 / www.baumhydraulics.com / © Baum Hydraulics Corporation

BAUM HYDRAULICS CORPORATION

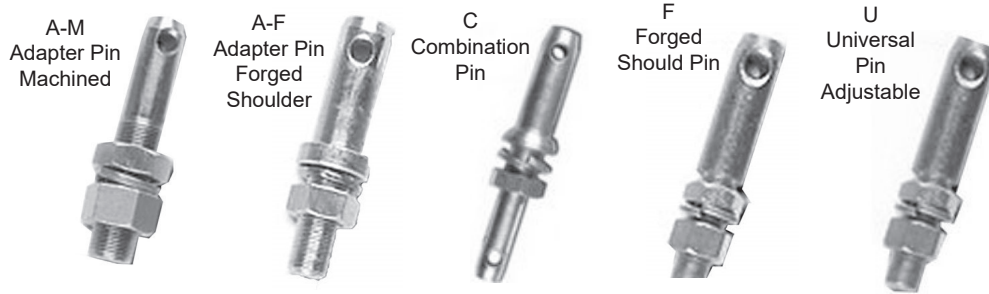

LIFT ARM PIN								
<ul style="list-style-type: none"> • Lift arm pins connect implement to lift arms on tractor • Category 0 through Category 3 • Nut(s) and washer included • Yellow zinc plated to resist corrosion 								
P/N	Cat	Dia	Thread	Usable Length	Overall Length	Pin Type	Wt Ea	Price
21210	0 Adjustable	5/8"	5/8NF	1-1/4"+	3-7/8"	U	.044	\$3.16
21212	0-1	7/8"	5/8NF	1-3/4"	4-1/2"	A-M	0.70	5.85
21222	1 Adjustable	7/8"	7/8NF	1-5/8"+	5"	U	1.12	6.12
21226	1 Forged	7/8"	7/8NF	1-3/4"	5-1/2"	F	1.15	4.43
21233	1 Adjustable	7/8"	7/8NF	2"+	6-3/8"	U	1.25	8.22
21224	1 Forged	7/8"	7/8NF	2-1/4"	6-3/4"	F	1.32	6.64
21230	1-2	1-1/8"	7/8NF	1-3/4"	5-1/4"	A-M	1.35	9.66
21232	1-2 Forged	1-1/8"	7/8NF	1-3/4"	5-1/4"	A-F	1.48	8.73
21235	1-2 Adjustable Forged	7/8" & 1-1/8"	1nf	2" Both	7-3/4"	C	1.95	19.42
21240	1-2 Forged	1-1/8"	7/8NF	2-1/4"	6-1/2"	A-F	1.68	11.64
21241	2 Adjustable	1-1/8"	1-1/8NF	1-3/4"+	6-1/8"	U	2.30	11.78
21242	2 Forged	1-1/8"	1-1/8NF	2"	6-1/8"	F	2.21	11.86
21243	2-1 Forged	7/8"	1-1/8NF	1-5/8"	5-3/4"	F	1.72	15.72
21244	2-3 Forged	1-7/16"	1-1/8NF	1-7/8"	5-3/4"	F(M)	2.82	22.20
21280	3 Forged	1-7/16"	1-3/8NF	1-7/8"	5-7/8"	F	3.70	25.22

Example: P/N 21230 Lift Arm Pin adapts Category 1 implement to Category 2 tractor hitch.
 P/N 21243 Lift Arm Pin adapts Category 2 implement to Category 1 tractor hitch.

ASK FOR QUANTITY DISCOUNT Prices subject to change without notice.



1-800-228-9222 / e-mail: sales@baumhydraulics.com
 Fax: 1-800-832-2522 / www.baumhydraulics.com / © Baum Hydraulics Corporation

THREE POINT LINKAGE PARTS

ADJUSTABLE & FORGED DRAW PINS & BUSHINGS

C07



MILLER ADJUSTABLE PLATED DRAW PINS

For 3-Point Hook-Up Tools
Shoulder adjusts to various
stabilizer arm spacings.
Cold rolled steel.
Di-chromate plated.

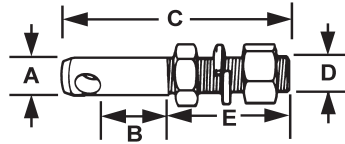

Part Number	A Pin Diam. Inches	B Useable Length Inches	C Thread Overall Inches	D Thread Diam. Inches	Price Per Piece
Category 1 with Washer and 2 Nuts - Adjustable Regular Type					
LA-1	7/8 Long	1-3/4	5-1/4	7/8	\$....
Category 2 with Washer and 2 Nuts - Adjustable Regular Type					
LA-2	1-1/8 Long	1-15/16	6-1/4	1-1/8

BUSHINGS -
Made of seamless cold rolled tubing.
Heat treated and di-chromate plated.



Miller Part Number	I.D. Size Inches	O.D. Size Inches	Length Inches	Price Per Piece
Draw Pin Bushing - Category 1 to 2				
AB1-2	7/8	1-1/8	1-3/4	\$....

FORGED STEEL WITH SHOULDER

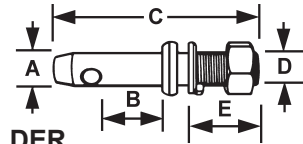

Part Number	A Pin Diam. Inches	C Length Overall Inches	D Thread Diam. Inches	Price Per Piece
Category 1 to 2 with Washer and 1 Nuts - Forged Steel Reducing Type				
LA1-2	1-1/8 Long	2-1/4	7/8	\$....

TRACTOR CATEGORY DEFINITIONS

(Per ASAE Standards)

Tractor Horsepower	Linkage Dimensions		
	Top Link Pin	Lift Arm Pin	
Category 0	Up to 20	5/8	5/8
Category 1	20 to 45	3/4	7/8
Category 2	40 to 100	1	1-1/8
Category 3	80 and over	1-1/4	1-7/16

- WIRELOCK PIN**
- Shaft diameters from 1/4" to 3/8"
 - Round or square wire lock
 - Yellow zinc plated

Bulk								Std. Pkg. = 100 pieces							
P/N	Shaft Dia	Usable Length	Shank Length	Overall Length	Wt Ea	Wire	Price	P/N	Shaft Dia	Usable Length	Shank Length	Overall Length	Wt Ea	Wire	Price
21968	1/4"	1-3/8"	1-11/16"	2"	.056	Round	\$1.17	21968	1/4"	1-3/8"	1-11/16"	2"	.056	Round	\$1.17
21970	1/4"	1-3/4"	2"	2-1/4"	.060	Round	1.28	21970	1/4"	1-3/4"	2"	2-1/4"	.060	Round	1.28
21971	1/4"	2-1/4"	2-3/4"	3"	.079	Square	1.33	21971	1/4"	2-1/4"	2-3/4"	3"	.079	Square	1.33
21973	1/4"	2-1/2"	2-7/8"	3-3/16"	.076	Round	1.33	21973	1/4"	2-1/2"	2-7/8"	3-3/16"	.076	Round	1.33
21972	1/4"	2-1/2"	2-7/8"	3-3/16"	.081	Square	1.33	21972	1/4"	2-1/2"	2-7/8"	3-3/16"	.081	Square	1.33
21974	5/16"	1-1/4"	1-1/2"	1-13/16"	.075	Round	1.22	21974	5/16"	1-1/4"	1-1/2"	1-13/16"	.075	Round	1.22
21975	5/16"	1-3/8"	1-5/8"	1-7/8"	.080	Round	1.09	21975	5/16"	1-3/8"	1-5/8"	1-7/8"	.080	Round	1.09
21978	5/16"	1-3/4"	2"	2-1/4"	.090	Round	1.22	21978	5/16"	1-3/4"	2"	2-1/4"	.090	Round	1.22
21980	5/16"	2-1/4"	2-3/4"	3"	.106	Square	1.22	21980	5/16"	2-1/4"	2-3/4"	3"	.106	Square	1.22
21982	5/16"	2-1/4"	2-3/4"	3"	.101	Round	1.28	21982	5/16"	2-1/4"	2-3/4"	3"	.101	Round	1.28
21983	5/16"	2-1/2"	2-7/8"	3-1/8"	.107	Round	1.12	21983	5/16"	2-1/2"	2-7/8"	3-1/8"	.107	Round	1.12
21985	5/16"	2-1/2"	2-7/8"	3-1/8"	.105	Square	1.28	21985	5/16"	2-1/2"	2-7/8"	3-1/8"	.105	Square	1.28
21996	5/16"	3-1/2"	3-15/16"	4-1/4"	.120	SqSqCoil	1.63	21996	5/16"	3-1/2"	3-15/16"	4-1/4"	.120	SqSqCoil	1.63
21987	5/16"	3-1/2"	3-3/4"	4"	.120	Sq. Sq	1.50	21987	5/16"	3-1/2"	3-3/4"	4"	.120	Sq. Sq	1.50
21990	3/8"	1-1/2"	1-3/4"	2"	.0100	Round	1.20	21990	3/8"	1-1/2"	1-3/4"	2"	.0100	Round	1.20
21992	3/8"	1-3/4"	2"	2-5/16"	.120	Round	1.20	21992	3/8"	1-3/4"	2"	2-5/16"	.120	Round	1.20
21984	3/8"	2-1/4"	2-1/2"	2-3/4"	.140	Square	1.28	21984	3/8"	2-1/4"	2-1/2"	2-3/4"	.140	Square	1.28
21986	3/8"	2-1/4"	2-1/2"	2-3/4"	.140	Round	1.36	21986	3/8"	2-1/4"	2-1/2"	2-3/4"	.140	Round	1.36
21997	3/8"	2-1/2"	2-3/4"	3"	.134	Round	1.20	21997	3/8"	2-1/2"	2-3/4"	3"	.134	Round	1.20
21994	3/8"	2-1/2"	2-3/4"	3"	.152	Square	1.44	21994	3/8"	2-1/2"	2-3/4"	3"	.152	Square	1.44
21998	3/8"	3"	3-1/4"	3-7/16"	.143	SqSqCoil	1.71	21998	3/8"	3"	3-1/4"	3-7/16"	.143	SqSqCoil	1.71
21999	3/8"	3-7/16"	3-11/16"	4"	.178	Square	1.74	21999	3/8"	3-7/16"	3-11/16"	4"	.178	Square	1.74

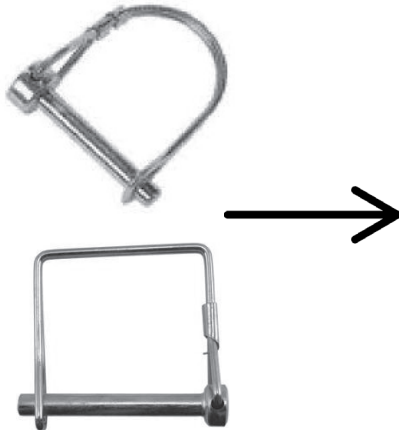

Prices subject to change without notice. **ASK FOR QUANTITY DISCOUNT**

1-800-228-9222 / e-mail: sales@baumhydraulics.com
Fax: 1-800-832-2522 / www.baumhydraulics.com / © Baum Hydraulics Corporation

BAUM HYDRAULICS CORPORATION

TOP LINKS, PINS, CYLINDERS & DRAWBARS



POWER TAKE-OFF MILLER LOCK PINS

Part Number	Pin Diam. Inches	Head Diam. Inches	Useable Length Inches	Wt. Lbs.	Price Per Piece
516-22LP	5/16	5/8	2-5/8	1/10	\$1.56
38-20LP	3/8	5/8	2-1/4	1/10	1.59
For 03-34-00037 use 516-22LP					

TOP LINK PINS -

Di-Chrome Plated



Miller Part Number	Pin Diam.	Length Overall Inches	Useable Length Inches	Price Per Piece
Category 2				
TLP4250	1	6	4-1/4	\$...



POWER TAKE-OFF MILLER LYNCH PINS

Part Number	Pin Diam. Inches	Head Diam. Inches	Useable Length Inches	Wt. Lbs.	Price Per Piece
38-13LP	3/8	5/8	1-1/2	1/10	\$1.49
14-16LP	1/4	1/2	1-3/4	1/10	1.56

KLIK PINS

For Three Point Hitches - Full Lock Design.
Fits any hole requiring a lynch pin.

DANUSER®

DANUSER KLIK PINS - Di-chromate plated. Forged Pin complete with snap lock ring. 7/16 x 11/32 pins have one flat side.
Pkg. Qty. = 4 Pieces

WITHOUT CHAIN		WITH CHAIN					
Without Chain Part Number	Price Per Piece	With Chain Part Number	Price Per Piece	A Pin Diam. Inches	B Inside Ring Diam. Inches	C Shank Length Pin Inches	D Overall Length Pin Inches
Standard Long-Shank Pin-Ring Will Not Fit Over End of Pin							
7524	\$3.44	7525	7/16	1-7/8	2	2-7/16
1533	3.18	----	7/16	1-3/8	1-3/4	2-3/16
Balck Ring Heavy Duty Long-Shank Pin-Ring Will Not Fit Over End of Pin							
7631	7634	7/16	1-3/8	1-3/4	2-3/16
7862	3.93	----	7/16	1-5/8	2	2-7/16
Safety Lock Long-Shank Pin-Ring Will Not Fit Over End of Pin							
9656	4.75	9655	7/16	1-3/4	2	2-7/16
Long Shank Pin-Ring Will Not Fit Over End of Pain							
7637	1.29	----	3/16	1	1-1/4	1-35/64
1600	1.33	1601	2.24	1/4	1-3/8	1-3/4	2-9/64
7618	2.11	7619	5/16	1-5/8	2-11/32	2-47/64

Picture With Chain

Without Chain

1600, 7618, 7637

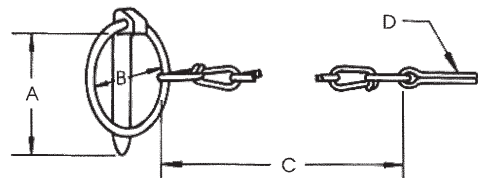

7525

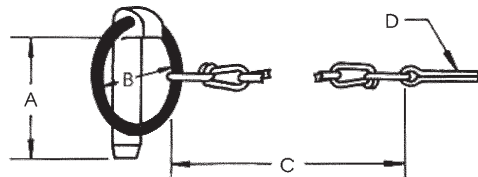
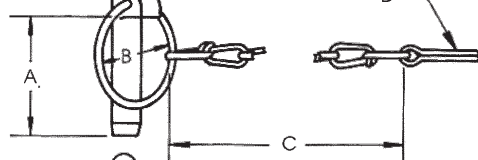

7634

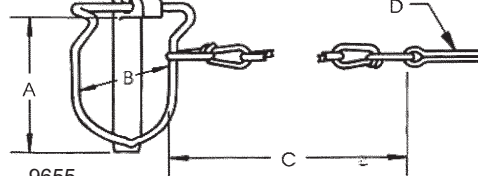

9655

Prices subject to change without notice. **ASK FOR QUANTITY DISCOUNT**



LYNCHPIN

- Lynchpins in sizes 3/16" to 7/16"
- Fit category 0-3 top link pins and lift arm pins
- Yellow zinc plated

Bulk								Std. Pkg. = 100 pieces							
P/N	Wt Ea	Description	Category	Usable Length	Shank Length	Overall Length	Price								
21910	.032	3/16" Lynchpin	0	1-1/8"	1-3/8"	1-5/8"	\$0.63								
21915	.142	3/16" Lynchpin w/12" chain	0	1-1/8"	1-3/8"	1-5/8"	1.37								
21920	.050	1/4" Lynchpin	1	1-1/4"	1-3/4"	2-1/8"	0.63								
21925	.160	1/4" Lynchpin w/12" chain	1	1-1/4"	1-3/4"	2-1/8"	1.71								
21930	.069	5/16" Lynchpin	1,2	1-1/4"	1-3/4"	2-1/8"	0.73								
21935	.179	5/16" Lynchpin w/12" chain	1,2	1-1/4"	1-3/4"	2-1/8"	...								
21940	.110	7/16" Lynchpin	1,2	1-1/4"	1-3/4"	2"	0.65								
21945	.206	7/16" Lynchpin w/12" chain	1,2	1-1/4"	1-3/4"	2"	1.71								
21938	.110	7/16" Lynchpin	1,2,3	1-7/16"	2"	2-7/16"	0.82								
21960	.130	7/16" Lynchpin w/ HD ring	1,2,3	1-1/2"	1-3/4"	2-1/8"	1.31								

WIRE LOCK HITCHPIN

- Hitchpin with coil tension
- High carbon steel
- Spring steel wire holds pin in place

Std. Pkg. = 12 pieces				
P/N	Pin Dia	Usable Length	WT Ea	Price
25113	1/2"	4-1/4"	0.50	\$6.20
25223	5/8"	4-1/4"	0.72	5.17
25233	3/4"	4-1/4"	1.00	5.79
25133	3/4"	6-1/4"	1.20	6.99
25143	7/8"	6-1/4"	1.60	8.60
25153	1"	6-1/4"	2.00	9.28



ZINC PLATED HEAT TREATED HITCHPIN

- One piece forged pin
- High carbon steel
- Spring wire handle
- Yellow zinc plated
- Heat treated to Rc 28-32

With 12" Chain & Lynchpin				
P/N	Shaft Dia	Usable Length	Wt Ea	Price
29808	3/8"	4"	.27	\$5.98
29810	1/2"	4"	.51	6.69
29816	1/2"	5-3/4"	.65	7.73
29821	5/8"	4"	.72	5.71
29826	5/8"	5-3/4"	.87	6.20
29832	3/4"	4"	.96	6.83
29836	3/4"	6-1/4"	1.20	10.69
29843	7/8"	7"	1.78	13.22
29854	1"	7"	2.19	11.86
29865	1-1/8"	7"	2.81	16.30
29876	1-1/4"	7"	3.35	27.56



STABILIZER PIN w/nut & washer

- Yellow zinc plated

Std. Pkg. = 12 Pieces							
P/N	Pin Dia	Thrd Dia	Usable Length	Overall Length	Description	Wt Ea	Price
21281	7/8"	5/8"	3/8"	2-5/8"	Stabilizer Pin	.40	\$2.69
21282	7/8"	5/8"	1/2"	2-7/8"	Stabilizer Pin	.42	3.70
21284	7/8"	3/4"	1/2"	3-1/8"	Stabilizer Pin	.57	2.69
21283	7/8"	5/8"	1"	3-1/8"	Anchor Pin	.40	4.14

Prices subject to change without notice. **ASK FOR QUANTITY DISCOUNT**

1-800-228-9222 / e-mail: sales@baumhydraulics.com
 Fax: 1-800-832-2522 / www.baumhydraulics.com / © Baum Hydraulics Corporation

BAUM HYDRAULICS CORPORATION



**ORANGE HANDLE
DETENT PIN**

- Easy to insert and remove
- Hi-visibility bright orange plastisol easy grip handle
- Features stainless steel ball locking mechanism in place of hitchpin clip or other fastener
- Zinc plated 1144 steel

Std. Pkg. = 1 piece

P/N	SHAFT Dia	Usable Length	WT Ea	Price
85301	5/16"	1"	.18	\$7.29
85302	5/16"	1-1/2"	.19	7.43
85303	5/16"	2"	.21	7.54
85304	5/16"	2-1/2"	.22	7.73
85305	5/16"	3"	.23	7.89
85306	5/16"	4"	.24	8.41
85310	3/8"	1"	.18	8.00
85311	3/8"	1-1/2"	.21	8.24
85312	3/8"	2"	.22	8.38
85313	3/8"	2-1/2"	.23	8.54
85314	3/8"	3"	.25	8.79
85315	3/8"	4"	.30	8.95
85320	1/2"	1"	.25	11.40
85321	1/2"	1-1/2"	.27	11.62
85322	1/2"	2"	.29	9.11
85323	1/2"	2-1/2"	.32	9.17
85324	1/2"	3"	.35	10.69
85325	1/2"	4"	.40	12.79
85330	5/8"	1-1/2"	.36	9.58
85331	5/8"	2"	.41	9.68
85332	5/8"	2-1/2"	.44	9.82
85333	5/8"	3"	.49	9.96
85334	5/8"	4"	.58	13.38
85335	5/8"	5"	.66	13.74
85340	3/4"	1-1/2"	.50	10.20
85341	3/4"	2"	.56	10.72
85342	3/4"	2-1/2"	.63	10.99
85343	3/4"	3"	.68	11.24
85344	3/4"	4"	.82	11.64
85345	3/4"	5"	.92	13.82

HITCHPIN

- The "original" hitchpins with the red plastisol coated head
- These pins are made of high tensile steel and heat treated
- Hairpin clip included

HEAVY DUTY HEAT TREATED HITCHPIN

P/N	HP No	Shaft Dia	Usable Length	Clip P/N	Wt Ea	Price
00103	H38	3/8"	4"	68838	0.38	\$5.71
00113	H12	1/2"	3-5/8"	68860	0.60	7.29
00223	H58-4	5/8"	4"	68870	0.90	5.61
00123	H58	5/8"	5-1/2"	68870	1.17	8.50
00233	H34-4	3/4"	4"	68870	1.07	9.68
00133	H34	3/4"	6-1/2"	68870	1.53	10.11
00243	H78-4	7/8"	4"	68870	1.40	12.27
00143	H78	7/8"	6-1/2"	68870	1.86	12.60
00253	H100-45	1"	4-1/2"	68880	2.00	10.91
00153	H100	1"	7-1/2"	68880	2.65	17.33
00353	H100-12	1"	12"	68880	3.60	43.34
00163	H1125	1-1/8"	8-1/2"	68880	3.64	23.42
00173	H1250	1-1/4"	8-1/2"	68880	4.33	29.48
00373	H1250-12	1-1/4"	12"	68880	5.50	55.74
00183	H1500	1-1/2"	8-1/2"	68884	6.48	42.18
00383	H1500-13	1-1/2"	13"	68884	8.60	82.81

ASK FOR QUANTITY DISCOUNT Prices subject to change without notice.



COTTERPIN				
<ul style="list-style-type: none"> • Hammerlock style • Clear zinc finish 				
Bulk		Std. Pkg. = 100 pieces		
P/N	Dia	Length	WT Ea	Price
60010	1/16"	1/2"	.0006	\$....
60020	1/16"	3/4"	.0008
60030	1/16"	1"	.0013
60033	1/16"	1-1/2"	.0020	0.09
60035	3/32"	3/4"	.0015
60040	3/32"	1"	.0018
60050	3/32"	1-1/2"	.0020
60060	1/8"	1"	.0044
60065	1/8"	1-1/4"	.0048
60070	1/8"	1-1/2"	.0050
60072	1/8"	2"	.0056
60080	5/32"	1"	.0070
60090	5/32"	1-1/2"	.0100
60094	5/32"	2-1/2"	.0200	0.22
60095	3/16"	1"	.0110
60100	3/16"	1-1/2"	.0130	0.13
60110	3/16"	2"	.0180
60112	3/16"	2-1/2"	.0200
60113	3/16"	3"	.0250	0.21
60115	1/4"	1-1/2"	.0242	0.26
60120	1/4"	2"	.0310
60130	1/4"	2-1/2"	.0378
60131	1/4"	3"	.0500	0.33
60138	5/16"	1-1/2"	.0375	0.48
60140	5/16"	2"	.0400	0.34
60150	5/16"	2-1/2"	.0530	0.42
60151	5/16"	3"	.0625	0.46
06158	3/8"	2"	.0625	0.51
60160	3/8"	2-1/2"	.0813	0.59

ADJUSTABLE CLEVIS PIN				
<ul style="list-style-type: none"> • Multiple holes • Cut off excess length if needed • Clear zinc plated 				
Bulk		Std. Pkg. = 100 pieces		
P/N	Dia	Length	WT Ea	Price
62710	3/16"	2"	.013	\$0.45
62715	1/4"	1"	.017	0.68
62720	1/4"	2"	.025	0.71
62721	1/4"	2-1/2"	.036	0.92
62722	1/4"	3"	.042	0.95
62725	5/16"	1"	.025	0.71
62726	5/16"	1-1/2"	.034	0.72
62730	5/16"	2"	.042	0.69
62732	5/16"	3"	.062	0.99
62735	3/8"	1"	.040	0.78
62736	3/8"	1-1/2"	.052	0.91
62740	3/8"	2"	.060	0.94
62741	3/8"	2-1/2"	.081	1.56
62742	3/8"	3"	.092	1.80
62743	3/8"	3-1/2"	.106	1.93
62744	3/8"	4"	.124	1.49
62750	7/16"	2"	.090	0.94
62755	7/16"	2-1/2"	.108	1.91
62758	7/16"	3"	.122	2.14
62760	1/2"	2"	.112	1.46
62765	1/2"	2-1/2"	.134	1.51
62768	1/2"	3"	.160	2.65
62769	1/2"	3-1/2"	.184	2.76
62770	1/2"	4"	.216	2.82
62780	5/8"	3"	.264	3.66
62790	3/4"	3"	.386	5.21

Prices subject to change without notice. **ASK FOR QUANTITY DISCOUNT**

1-800-228-9222 / e-mail: sales@baumhydraulics.com
 Fax: 1-800-832-2522 / www.baumhydraulics.com / © Baum Hydraulics Corporation

BAUM HYDRAULICS CORPORATION



CLEVIS PIN • Plain finish									
Bulk		Std. Pkg. = 100 pieces			Bulk		Std. Pkg. = 100 pieces		
P/N	Dia	Usable Length	Wt Ea	Price	P/N	Dia	Usable Length	Wt Ea	Price
63606	3/16"	1"	.0088	\$0.00	63682	3/8"	3"	.0975	\$0.27
63607	3/16"	1-1/4"	.0106	0.00	63688	7/16"	1-1/2"	.0732	0.29
63608	3/16"	1-1/2"	.0131	0.00	63689	7/16"	1-3/4"	.0825	0.30
63609	3/16"	1-3/4"	.0150	0.00	63690	7/16"	2"	.0925	0.33
63610	3/16"	2"	.0169	0.00	63698	1/2"	1"	.0675	0.34
63619	1/4"	1"	.0169	0.00	63701	1/2"	1-1/2"	.0950	0.30
63621	1/4"	1-1/4"	.0200	0.00	63703	1/2"	2"	.1200	0.31
63623	1/4"	1-1/2"	.0231	0.00	63704	1/2"	2-1/4"	.1332	0.38
63624	1/4"	1-5/8"	.0250	0.00	63705	1/2"	2-1/2"	.1475	0.36
63625	1/4"	1-3/4"	.0269	0.00	63707	1/2"	3"	.1725	0.40
63626	1/4"	1-7/8"	.0281	0.00	63709	1/2"	3-1/2"	.2000	0.41
63627	1/4"	2"	.0300	0.00	63711	1/2"	4"	.2250	0.44
63629	1/4"	2-1/4"	.0331	0.00	63715	1/2"	5"	.2800	0.42
63632	1/4"	2-1/2"	.0369	0.00	63732	5/8"	1-1/2"	.1600	0.42
63637	1/4"	3"	.0450	0.00	63736	5/8"	2"	.2000	0.46
63646	5/16"	1"	.0244	0.00	63740	5/8"	2-1/2"	.2438	0.36
63649	5/16"	1-1/4"	.0300	0.00	63745	5/8"	3"	.2813	0.45
63651	5/16"	1-1/2"	.0350	0.00	63749	5/8"	4"	.3563	0.55
63652	5/16"	1-3/4"	.0400	0.00	63757	5/8"	6"	.5500	0.51
63653	5/16"	1-7/8"	.0450	0.00	63780	3/4"	2"	.2875	0.52
63654	5/16"	2"	.0480	0.00	63789	3/4"	3"	.4200	0.53
63656	5/16"	2-1/4"	.0525	0.00	63793	3/4"	4"	.5375	0.54
63658	5/16"	2-1/2"	.0575	0.00	63797	3/4"	5"	.6525	0.58
63659	5/16"	2-5/8"	.0600	0.00	63803	3/4"	6-1/2"	.8500	0.38
63660	5/16"	2-3/4"	.0629	0.00	63812	7/8"	2"	.3813	0.70
63661	5/16"	3"	.0688	0.00	63820	7/8"	3"	.5525	0.76
63665	3/8"	1"	.0370	0.00	63828	7/8"	4"	.7375	0.47
63668	3/8"	1-1/4"	.0425	0.00	63836	7/8"	6"	1.0525	0.50
63671	3/8"	1-1/2"	.0525	0.00	63843	1"	2-1/2"	.6300	0.60
63673	3/8"	1-3/4"	.0575	0.00	63845	1"	3"	.7563	0.65
63675	3/8"	2"	.0675	0.00	63853	1"	4"	.9750	0.70
63677	3/8"	2-1/4"	.0725	0.00	63861	1"	6"	1.4188	0.70

ASK FOR QUANTITY DISCOUNT Prices subject to change without notice.

BAUM HYDRAULICS CORPORATION

1-800-228-9222 / e-mail: sales@baumhydraulics.com
 Fax: 1-800-832-2522 / www.baumhydraulics.com / © Baum Hydraulics Corporation



CYLINDER PIN

- Precision machined pin with grooves and holes for easy use
- Includes two hairpin clips
- Clear zinc plated

Std. Pkg. = 24 Pieces

P/N	Pin No	Pin Dia	Usable Length	Overall Length	Clip P/N	Wt Ea	Price
10200	CP225	1"	2-1/4"	3"	60870	0.70	5.30
10202	CP275	1"	2-3/4"	3-1/2"	60870	0.82	7.86
10205	CP300	1"	3"	3-3/4"	60870	0.88	7.86
10210	CP325	1"	3-1/4"	4"	60870	0.95	8.92
10217	CP1325	1-1/4"	3-1/4"	4"	60880	1.44	13.74

CLEVIS PIN (Non-Threaded)

Std. Pkg. = 12 Pieces

P/N	Cat	Diameter	Usable Length	Overall Length	Wt Ea	Price
21295	2	1-1/8"	3-3/8"	4-3/4"	1.30	\$9.19
21290	2	1-1/8"	4-3/4"	6-1/4"	1.76	8.84
21291	2	1-1/8"	7-5/8"	9-1/4"	2.50	10.42
21293	2-3	1-1/8" & 1-7/16"	3-1/2" & 4-1/2"	9-1/4"	3.85	21.11
21292	3	1-7/16"	4-11/16"	6-1/4"	2.80	17.25



BENT PIN

- Economical universal pin for use on agricultural, industrial, recreational and construction equipment
- Easy to install and remove replacement for clevis pin
- Clear zinc plated
- Includes hairpin clip

Std. Pkg. = 1 Pieces

P/N	Pin Dia	Usable Length	Overall Length	Clip P/N	Wt Ea	Price
10302	5/16"	2-1/2"	4"	60830	0.10	\$3.05
10303	5/16"	3"	4-3/4"	60830	0.11	4.76
10305	3/8"	2-1/2"	4"	60830	0.15	2.34
10306	3/8"	3"	4-3/4"	60830	0.16	3.24
10307	3/8"	3-1/2"	5"	60830	0.20	3.29
10308	3/8"	4"	5-1/2"	60830	0.21	3.73
10310	1/2"	2-1/2"	4"	60860	0.25	2.99
10312	1/2"	3"	4-3/4"	60860	0.28	3.13
10314	1/2"	4"	5-3/4"	60860	0.34	3.51
10315	1/2"	4-1/2"	6-1/4"	60860	0.38	2.97
10316	1/2"	5"	7"	60860	0.40	3.94
10320	5/8"	3"	5"	60870	0.50	3.78
10322	5/8"	4"	6"	60870	0.57	4.35
10326	5/8"	5"	7-1/4"	60870	0.72	5.47
10330	3/4"	3-1/2"	5-1/2"	60870	0.85	5.82
10332	3/4"	4-1/2"	6-1/2"	60870	0.96	7.26
10336	3/4"	5"	7-1/2"	60870	1.02	7.54

SET COLLAR

- Heavy duty, precision machined for quality fit and ease of installation
- Fitted with allen head set screw
- Packaged in individual plastic bag
- Clear zinc plated

Std. Pkg. = 100 pieces

P/N	Desc	ID	OD	Width	Wt Ea	Price
10608	SC250	1/4"	1/2"	5/16"	.01	\$1.71
10609	SC312	5/16"	5/8"	5/16"	.02	1.71
10610	SC375	3/8"	3/4"	3/8"	.04	1.82
10611	SC437	7/16"	7/8"	7/16"	.05	1.88
10612	SC500	1/2"	1"	7/16"	.08	1.93
10613	SC562	9/16"	1"	7/16"	.11	1.93
10614	SC625	5/8"	1-1/4"	9/16"	.12	2.01
10616	SC750	3/4"	1-1/2"	9/16"	.14	4.00
10617	SC812	13/16"	1-5/16"	9/16"	.16	2.37
10618	SC875	7/8"	1-1/2"	9/16"	.18	2.75
10620	SC937	15/16"	1-5/8"	9/16"	.20	2.77
10622	SC1000	1"	1-5/8"	9/16"	.23	2.83
10623	SC1062	1-1/16"	1-3/4"	5/8"	.25	2.91
10624	SC1125	1-1/8"	1-3/4"	11/16"	.32	3.02
10626	SC1187	1-3/16"	2"	11/16"	.44	3.59
10628	SC1250	1-1/4"	2"	11/16"	.45	3.75
10630	SC1375	1-3/8"	2-1/8"	3/4"	.50	4.19
10632	SC1437	1-7/16"	2-1/4"	3/4"	.60	8.46
10634	SC1500	1-1/2"	2-1/4"	3/4"	.65	4.90
10636	SC1625	1-5/8"	2-1/2"	13/16"	.66	6.12
10638	SC1750	1-3/4"	2-5/8"	7/8"	.73	7.05
10640	SC1875	1-7/8"	2-3/4"	7/8"	.78	7.10
10642	SC2000	2"	3"	7/8"	1.03	8.03

Prices subject to change without notice. **ASK FOR QUANTITY DISCOUNT**

C14



HITCHPIN CLIP								
• Spring steel wire								
• Clear zinc plated								
Bulk				Std. Pkg. = 100 pieces				
P/N	Wire Dia	Overall Length	Inside Dia of Eye	Fits Hole	Fits Shaft	Clip No	Wt Ea	Price
60810	.042	1"	1/4"	3/64"	3/16" to 1/4"	223	.0012	\$0.16
60818	.054	3/4"	1/8"	1/16"	3/16" to 1/4"	236	.0021	0.20
60820	.054	7/8"	9/64"	1/16"	1/4" to 3/8"	237	.0024	0.09
60821	.062	1-5/16"	5/16"	5/64"	5/16" to 1/2"	222	.0030	0.12
06830	.072	1-3/32"	9/64"	5/64"	5/16" to 3/8"	225	.0030	0.10
60837	.080	1-9/16"	5/16"	3/32"	3/8" to 1/2"	217	.0063	0.16
60838	.093	1-5/8"	3/8"	7/64"	3/8" to 5/8"	203	.0070	0.11
60840	.093	2"	5/8"	7/64"	1/4" to 1/2"	228	.0095	0.28
60839	.093	2-1/2"	7/16"	7/64"	3/8" to 3/4"	214	.0063	0.16
60842	.093	2-5/16"	5/8"	7/64"	1/4" to 5/8"	207	.0135	0.23
60845	.125	2-1/2"	1/2"	9/64"	5/8" to 7/8"	227	.0200	0.26
60850	.125	2-9/16"	9/16"	9/64"	7/16" to 3/4"	211	.0196	0.39
60860	.125	1-15/16"	7/16"	9/64"	1/2" to 3/4"	216	.0148	0.33
60870	.148	2-15/16"	3/4"	5/32"	5/8" to 1"	210	.0332	0.50
60878	.177	3-1/4"	7/8"	3/16"	5/8" to 1"	206	.0515	0.75
60880	.177	3-3/4"	15/16"	3/16"	7/8" to 1-1/4"	208	.0610	0.81
06884	.243	4"	15/16"	17/64"	3/4" to 1"	219	.1180	1.78
60886	.243	5-1/8"	1-3/8"	17/64"	1-1/4" to 1-1/2"	235	.1700	2.75
60890	.310	3-15/16"	7/8"	21/64"	7/8" to 1"	220	.1750	2.37

HITCHPIN CLIP				
• Spring steel wire				
• Yellow zinc plated				
Bulk		Std. Pkg. = 100 pieces		
P/N	Wire Dia	Overall Length	WT Ea	Price
68801	.028	.600	.0004	\$0.05
68810	.042	1"	.0012	0.08
68818	.054	3/4"	.0021	0.08
68820	.062	1-3/8"	.0024	0.13
68819	.062	1-9/16"	.0030	0.10
68821	.062	1-5/16"	.0030	0.11
68830	.078	1-3/32"	.0030	0.13
68837	.080	1-9/16"	.0063	0.10
68838	.093	1-5/8"	.0070	0.12
68840	.093	2"	.0095	0.17
68839	.093	2-1/2"	.0063	0.16
68844	.125	1-9/16"	.0130	0.19
68850	.125	2-5/8"	.0196	0.24
68860	.125	2-1/16"	.0148	0.27
68870	.156	3"	.0332	0.33
68878	.177	3-1/4"	.0515	0.65
68880	.177	3-3/4"	.0610	0.69
68884	.243	4"	.1180	1.78
68890	.310	3-15/16"	.1750	2.98

EXTERNAL HITCHPIN CLIP							
• General purpose snap-on clip							
• Spring steel wire							
• Clear zinc plated							
Bulk				Std. Pkg. = 100 Pieces			
P/N	Wire Dia	Overall Length	Wt Ea	Clip P/N	Fits Pin Groove	Inside Eye Dia	Price
60881	.028	9/32"	.0003	413X	5/64"	1/16"	\$0.08
60883	.032	15/32"	.0008	401X	5/32"	3/32"	0.09
60882	.035	1/2"	.0005	405X	5/32"	1/8"	0.08
60885	.047	7/8"	.0009	404X	1/4"	1/8"	0.09
60887	.102	2-1/16"	.0095	407X	25/32"	7/16"	0.19
60892	.125	2-1/16"	.0160	414X	25/32"	7/16"	0.37
60888	.177	2-3/4"	.0430	410X	11/16"	3/4"	0.70
60893	.187	2-7/8"	.0500	417X	3/4"	7/8"	0.66

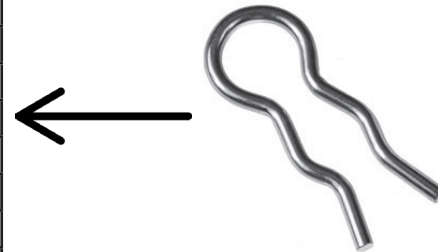

ASK FOR QUANTITY DISCOUNT Prices subject to change without notice.